

FLOODED BATTERY

079 (12V40Ah)



APPLICATIONS

- Car start
- EV/HEV
- Engine start

CHARACTERISTICS

Item	Specifications
Nominal Voltage	12V
Nominal Capacity (20HR)	40Ah
Reserve Capacity	61min
Cold Cranking Amps@0°F (-18°C)	370A
Dimension	Length
	207mm (8.15inches)
	Width
Dimension	175mm (6.89inches)
	Height
Dimension	190mm (7.48inches)
	Approx Weight
Terminal	11.8kg (26.0lbs)
	1
Cell layout	0
Hold-Down	B13
Case	Black-PP Material
Cover	Black-PP Material
Handle	TS2

GENERAL FEATURES

- High capacity and high CCA
- Long life
- Advanced lead-calcium alloy technology, maintenance-free design
- Patented venting system bring less water loss and prevent acid leakage
- OE quality certification

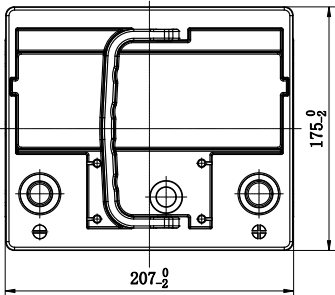
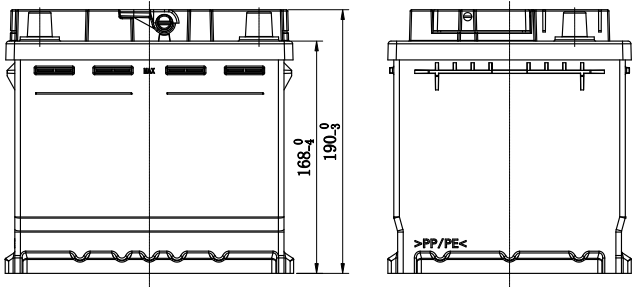
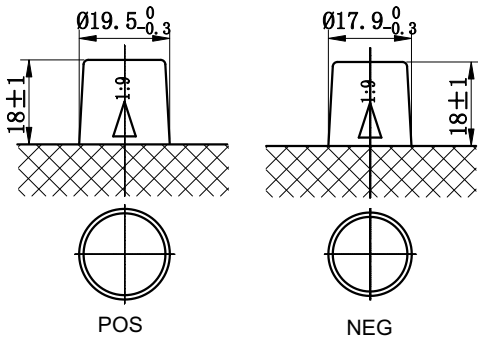

*Values are subject to variation of +/- 5% in normal manufacturing processes.