

Xtreme Dual Purpose

XR-2100 (12V100AH)

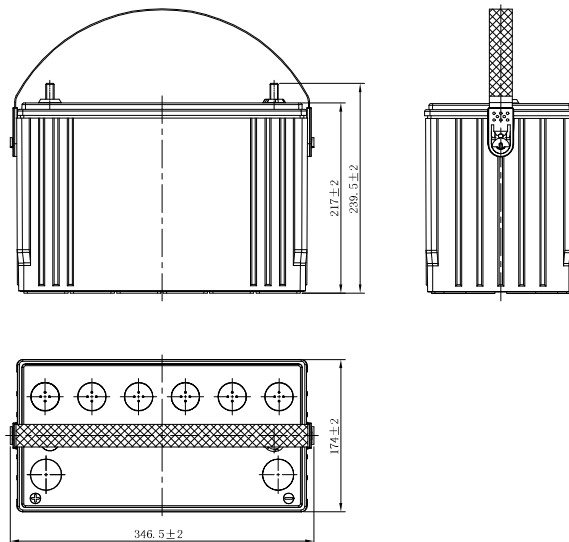

Layout



Standard Terminal

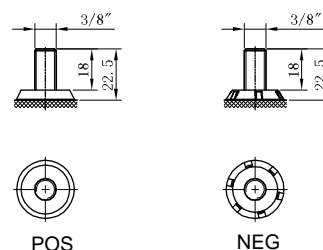

Specifications

Nominal Voltage	12V	
Dimensions	Length	346.5mm (13.6inches)
	Width	174mm (6.85inches)
	Container Height	217mm (8.54inches)
	Total Height	239.5mm (9.43inches)
Approx Weight	31.0Kg (68.3lbs)	
Terminal	13	
Container Material	PP	
Cell Layout	1	
Hold-Down	B0	
Handle	TS5	

Electrical Specification

Rated Capacity	20 hour rate (5.0A)	100Ah
Reserve Capacity	190min	
CCA(SAE)	850A	