

# Xtreme Dual Purpose

## XR-4000 (12V200AH)

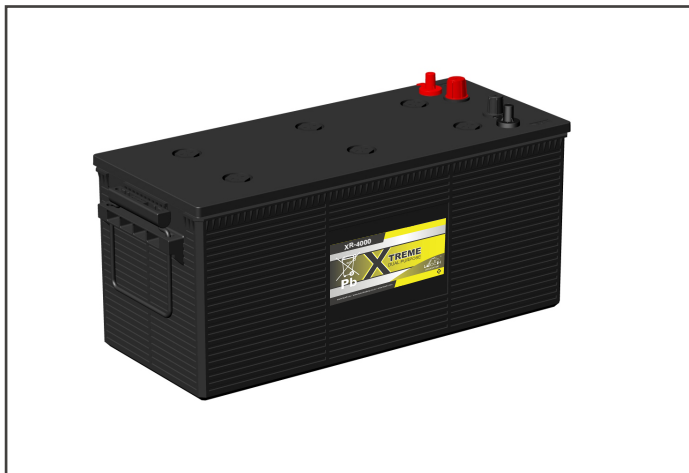

### Specifications

Nominal Voltage	12V	
Dimensions	Length	527mm (20.8inches)
	Width	214mm (8.43inches)
	Container Height	222mm (8.74inches)
	Total Height	244mm (9.61inches)
Approx Weight	55.1Kg (121.5lbs)	
Terminal	12	
Container Material	PP	
Cell Layout	4	
Hold-Down	B0	
Handle	TS8	

### Electrical Specification

Rated Capacity	20 hour rate (10.0A)	200Ah
Reserve Capacity	445min	
CCA(SAE)	950A	

### Layout

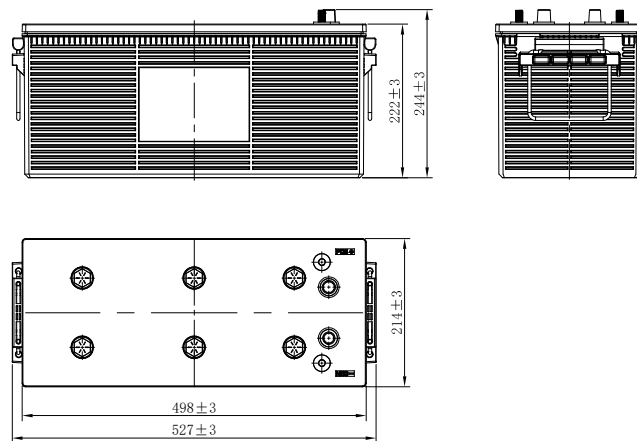

### Standard Terminal

